

**Features:**

- \* Available in Straight.
- \* Low profile 7.10mm (0.280").
- \* Dual beam contacts offer ultimate performance.

**Material:**

**Housing:** High temperature housing withstands IR and VPR soldering methods.

**Contacts:** Phosphor Bronze.

**Plating:** Gold plated over nickel.  
Tin plated over nickel.

**Electrical Characteristics:**

**Current Rating:** 1 AMP.

**Insulator Resistance:** 5000MΩmin. at DC 500V.

**Contact Resistance:** 20mΩmax. at DC 100mA.

**Operating Temperature:** -65°C ~ +125°C .

**Max Processing Temperature:** 230°C for 30~60 seconds.

**Mechanical Characteristics:**

**Insertion Force:** 140g avg.(0.64mm sq. pin)

**Withdrawal Force:** 114g avg.(0.64mm sq. pin)

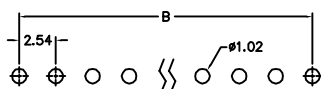
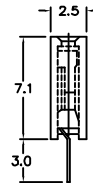
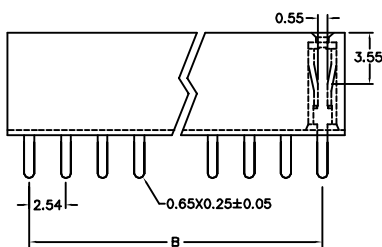
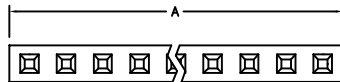

P.C. Board Layout

Position	3 Thru 40
Dimension	
A	2.54 X No. of Positions
B	2.54 X No. of Positions - 2.54

**Ordering information**

PS03- 1 40 1 1  
 Series Single Row No. of Pin Per Row 1: Gold Plated 2: Tin Plated 1: Straight